

# FUTEK MODEL QLA249

STOCK NUMBER: SEE CHART

# Custom Thru Hole Load Cell

INCH (mm)		R.O.= Rated Output	
WIRING CODE			
+Excitation	-Excitation	+Signal	-Signal
PIN A	PIN B	PIN C	PIN D
N/C			
PIN E			

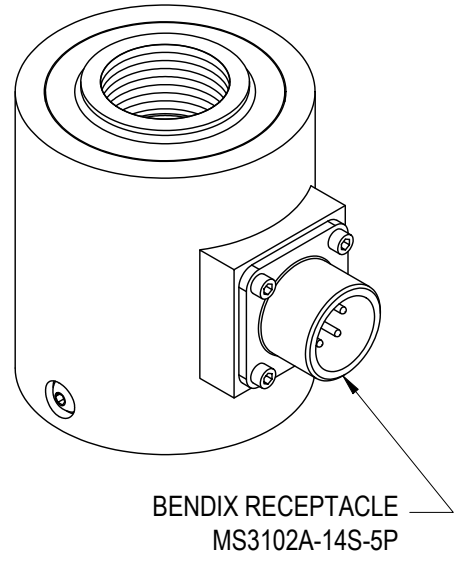
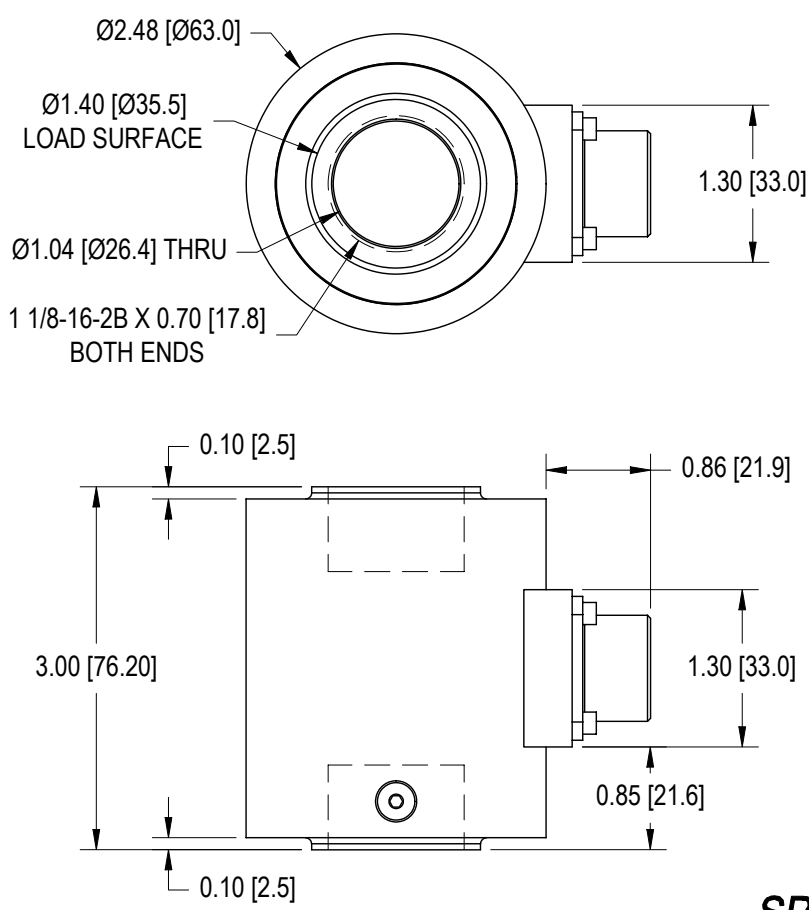
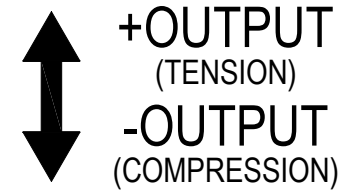

STK #	lb
QSH00638	2000
QSH00658	5000
QSH00661	10000

## SPECIFICATIONS:

RATED OUTPUT	3 mV/V nom.
ZERO BALANCE	±1% of R.O.
EXCITATION	18 VDC MAX
BRIDGE RESISTANCE	350 Ω nom.
NONLINEARITY	±0.5% of R.O.
HYSTERESIS	±0.5% of R.O.
TEMP. SHIFT ZERO	±0.02% of R.O./°F (0.04% of R.O./°C)
TEMP. SHIFT SPAN	±0.02% of LOAD/°F (0.04% of LOAD/°C)
COMPENSATED TEMP.	60 to 160°F (15 to 72°C)
OPERATING TEMP.	-60 to 200°F (-50 to 93°C)
WEIGHT	0.5 lb
MATERIAL	ALUMINUM
CONNECTOR: 5 Pin Bendix Receptacle MS3102A-14S-5P	

**DSPM Industria\***  
sensori & trasduttori

Via Paolo Uccello 4 - 20148 Milano  
Tel +39 02 48 009 757 Fax +39 02 48 002 070  
info@dspmindustria.it www.dspmindustria.it

MATERIAL:	—
HEAT TREATMENT - FINISH:	—

## OUTLINE DRAWING

STANDARD NOTES: (Unless Otherwise Specified)

- ALL DIMENSIONS ARE IN INCHES
- DRAWING INTERPRETATION DIMS. PER ASME-Y14.5M
- REMOVE BURRS AND BREAK SHARP EDGES .005 - .015
- THREADS PER HANDBOOK H-28
- DIMENSIONS ARE SHOWN AFTER PLATING

ANGLE: ±1/2°  
CHAMFER: ±5°  
TOLERANCE:  
.X ±0.1  
.XX ±0.01  
.XXX ±0.005

3rd ANGLE PROJ.

This drawing is submitted solely for the information and exclusive use of the original addressee. It is not to be divulged in whole or in part, by any firm or individual without written permission from:

**FUTEK**  
ADVANCED SENSOR TECHNOLOGY, INC.

CAGE: 1X8M6	
MODEL: <b>QLA249</b>	DWG No.: <b>FO1111</b>
DRAWN BY: H. AU	CHECKED BY: -
APPROVED BY: J. VARGAS	DATE: <b>OCT. 13, 2005</b>

REVISIONS: (Refer to dwg # revision sheet)  
▲ 1-03-07

# FUTEK MODEL QLA249

STOCK NUMBER: SEE CHART

# Custom Thru Hole Load Cell

INCH (mm)		R.O.= Rated Output	
WIRING CODE			
+Excitation	-Excitation	+Signal	-Signal
PIN A	PIN B	PIN C	PIN D
N/C			
PIN E			

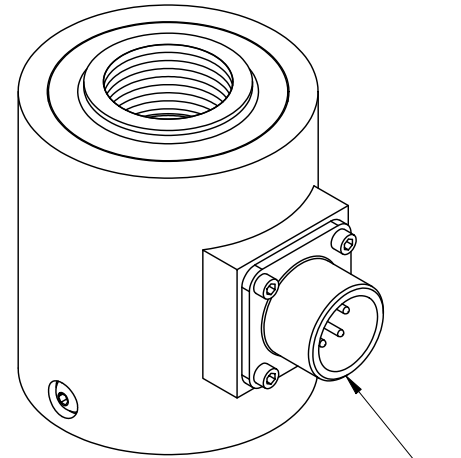
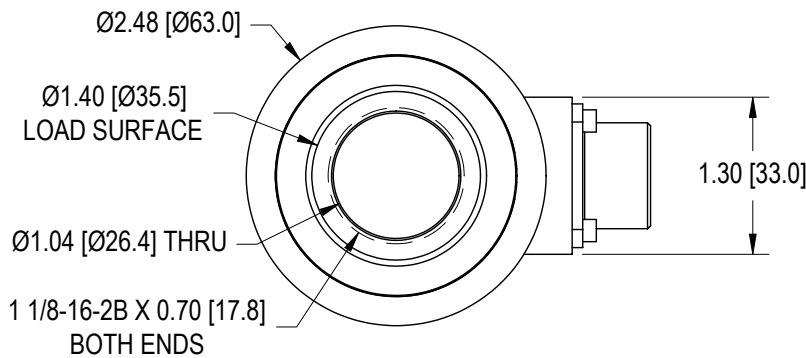
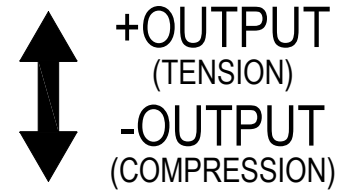

BENDIX RECEPTACLE  
MS3102A-14S-5P

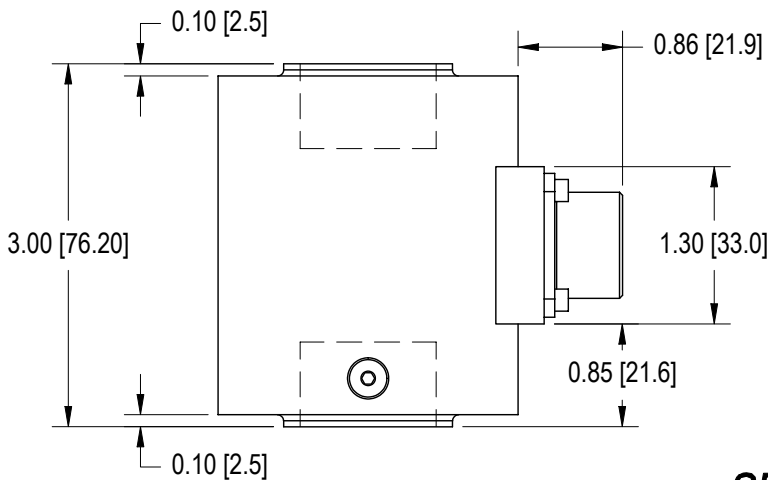

STK #	lb
QSH00638	2000
QSH00658	5000
QSH00661	10000

## SPECIFICATIONS:

RATED OUTPUT	3 mV/V nom.
ZERO BALANCE	±1% of R.O.
EXCITATION	18 VDC MAX
BRIDGE RESISTANCE	350 Ω nom.
NONLINEARITY	±0.5% of R.O.
HYSTERESIS	±0.5% of R.O.
TEMP. SHIFT ZERO	±0.02% of R.O./°F (0.04% of R.O./°C)
TEMP. SHIFT SPAN	±0.02% of LOAD/°F (0.04% of LOAD/°C)
COMPENSATED TEMP.	60 to 160°F (15 to 72°C)
OPERATING TEMP.	-60 to 200°F (-50 to 93°C)
WEIGHT	0.5 lb
MATERIAL	ALUMINUM
CONNECTOR:	5 Pin Bendix Receptacle MS3102A-14S-5P

**DSPM Industria**  
sensori & trasduttori

Via Paolo Uccello 4 - 20148 Milano

Tel +39 02 48 009 757 Fax +39 02 48 002 070  
info@dspmindustria.it www.dspmindustria.it

MATERIAL:

—

HEAT TREATMENT - FINISH:

—

REVISIONS: (Refer to dwg # revision sheet)  
1-03-07

## OUTLINE DRAWING

STANDARD NOTES: (Unless Otherwise Specified)

- ALL DIMENSIONS ARE IN INCHES
- DRAWING INTERPRETATION DIMS. PER ASME-Y14.5M
- REMOVE BURRS AND BREAK SHARP EDGES .005 - .015
- THREADS PER HANDBOOK H-28
- DIMENSIONS ARE SHOWN AFTER PLATING

ANGLE:  
±1/2°

CHAMFER:  
±5°

TOLERANCE:  
.X ±0.1  
.XX ±0.01  
.XXX ±0.005

3rd ANGLE PROJ.



This drawing is submitted solely for the information and exclusive use of the original addressee. It is not to be divulged in whole or in part, by any firm or individual without written permission from:

**FUTEK**  
ADVANCED SENSOR TECHNOLOGY, INC.

CAGE: 1X8M6

MODEL: QLA249

DWG No.: FO1111

DRAWN BY: H. AU

CHECKED BY: -

APPROVED BY: J. VARGAS

DATE: OCT. 13, 2005