

FUTEK MODEL QLA110 AMPLIFIED LOAD SENSING CLEVIS PIN

STOCK NUMBER: QSH00026

INCH (mm)		R.O. = Rated Output
WIRING CODE		
12-24 VDC	RETURN	0-5 VDC OUTPUT
PIN A	PIN B	PIN C

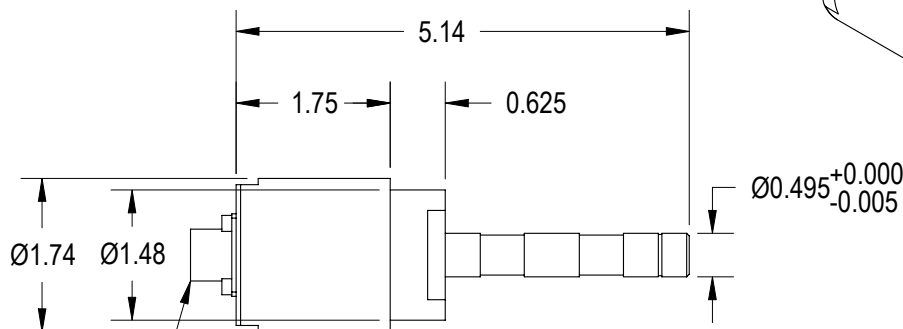
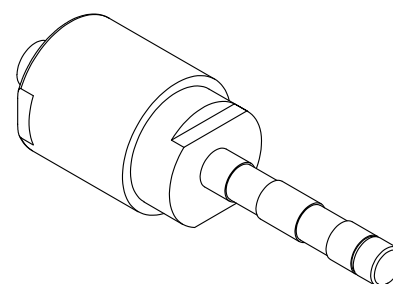

$\varnothing 0.495^{+0.000}_{-0.005}$

BENDIX RECEPTACLE
PT02A-10-6P
MATING CONNECTOR
PT06A-10-6S-SR
(NOT INCLUDED)

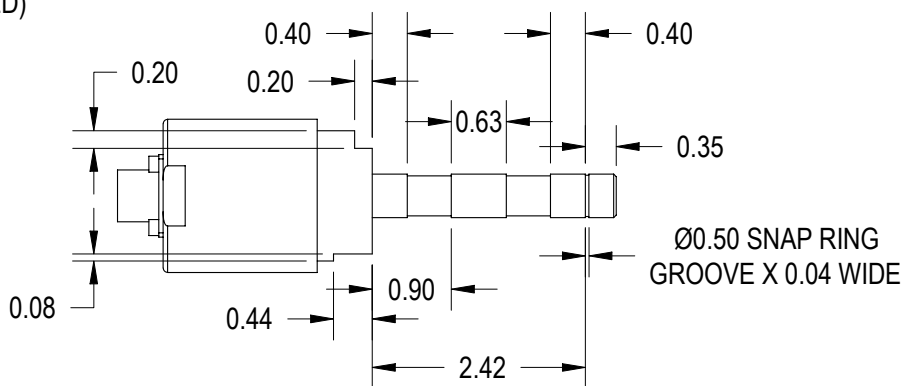

SPECIFICATIONS:

RATED OUTPUT	5 VDC <i>nom</i>
CAPACITY	1500 lb
SAFE OVERLOAD	150% of R.O.
ZERO BALANCE	2.5 ± 0.1 VDC A
EXCITATION (VDC OR VAC)	12-24 VDC
NONLINEARITY	±2% of R.O.
NONREPEATABILITY	±0.25% of R.O.
TEMP. SHIFT ZERO	±0.01% of R.O./°F
TEMP. SHIFT SPAN	±0.01% of LOAD/°F
COMPENSATED TEMP.	60 to 160°F
OPERATING TEMP.	-40 to 180°F
MATERIAL	STAINLESS STEEL
CONNECTOR: 6 Pin BENDIX Receptacle (PT02A-10-6P)	

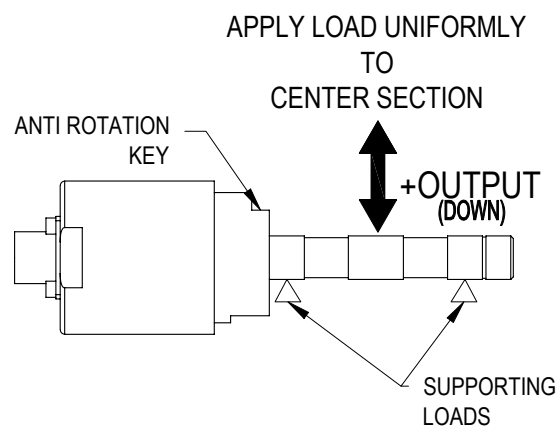

DSPM Industria*
sensori & trasduttori

Tel +39 02 48 009 757 Fax +39 02 48 002 070

Via Paolo Uccello 4 - 20148 Milano
info@dspmindustria.it www.dspmindustria.it

OUTLINE DRAWING

STANDARD NOTES: (Unless Otherwise Specified)

- ALL DIMENSIONS ARE IN INCHES
- DRAWING INTERPRETATION DIMS. PER ASME-Y14.5M
- REMOVE BURRS AND BREAK SHARP EDGES .005 - .015
- THREADS PER HANDBOOK H-28
- DIMENSIONS ARE SHOWN AFTER PLATING

ANGLE:
±1/2°

CHAMFER:
±5°

TOLERANCE:
.XX ±.01
.XXX ±.005

3rd ANGLE PROJ.

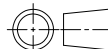

This drawing is submitted solely for the information and exclusive use of the original addressee. It is not to be divulged in whole or in part, by any firm or individual without written permission from:

FUTEK
ADVANCED SENSOR TECHNOLOGY, INC.

CAGE: 1X8M6

MODEL: QLA110

DWG No.: FO1023

DRAWN BY: J. VARGAS

CHECKED BY: XXXXX

APPROVED BY: R. WALKER

DATE: April 20, 2004

MATERIAL:

—

HEAT TREATMENT - FINISH:

—

REVISIONS: (Refer to dwg # revision sheet)

A 04-24-04