

FUTEK MODEL QLA285

PARALLEL BEAM LOAD CELL

ITEM NUMBER: SEE CHART



INCH [mm]		R.O. = Rated Output	
WIRING CODE			
+ Excitation	- Excitation	+ Signal	- Signal
RED	WHITE	BLUE	GREEN
Shield			
FLOATING			

PROTECTIVE COATING BOTH SIDES

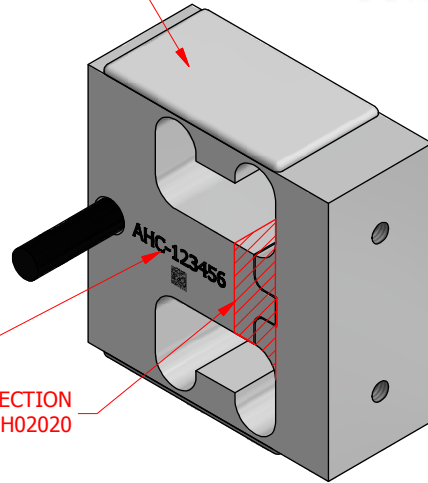

- OUTPUT
↑
↓
+ OUTPUT

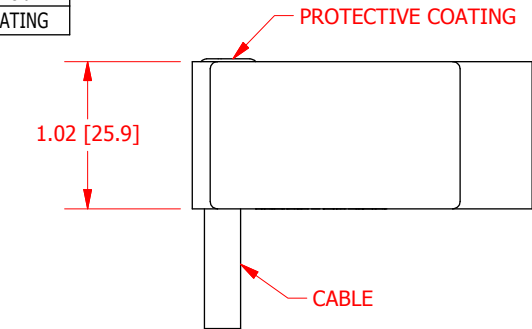

S/N WITH DATAMATRIX

OVERLOAD PROTECTION NOT AVAILABLE ON QSH02020

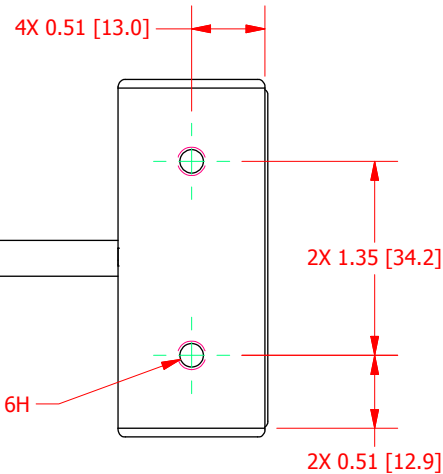
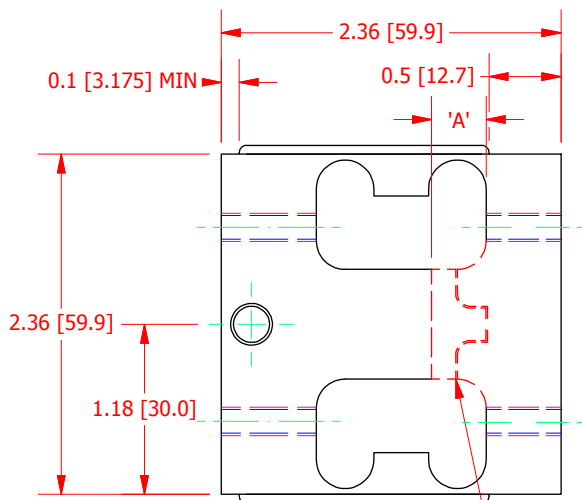

OVERLOAD PROTECTION NOT AVAILABLE ON QSH02020

SPECIFICATIONS:

RATED OUTPUT	2 mV/V nom.
CAPACITY	15 lb. [66.6N]
SAFE OVERLOAD	See Chart
ZERO BALANCE	±2% of R.O.
EXCITATION (VDC OR VAC)	18 MAX
BRIDGE RESISTANCE	350 Ω nom.
NONLINEARITY	±0.05% of R.O.
HYSTERESIS	±0.05% of R.O.
NONREPEATABILITY	±0.01% of R.O.
TEMP. SHIFT ZERO	±0.01% of R.O./°F (±0.018 of R.O./°C)
TEMP. SHIFT SPAN	±0.01% of LOAD/°F (±0.018 of LOAD/°C)
COMPENSATED TEMP.	60 to 160 °F (16 to 71 °C)
OPERATING TEMP	0 to 160 °F (-18 to 71 °C)
WEIGHT (approx)	0.4 lb [181.4 g]
MATERIAL	Aluminum
CABLE: #26 Awg 4 Conductor Shielded Cable, 8 in [20 cm] Long	
RoHS 2011/65/EU Compliant	

ITEM#	OVERLOAD PROTECTION	'A'	SAFE OVERLOAD
QSH02019	YES	0	150 lb [667 N]
QSH02020	NO	0.38 [9.65]	22.5 lb [100 N]

DSPM Industria*
sensori & trasduttori

Via Paolo Uccello 4 - 20148 Milano
Tel +39 02 48 009 757 Fax +39 02 48 002 070 info@dspmindustria.it www.dspmindustria.it

CUSTOMER APPROVAL- COMPANY:

CUSTOMER APPROVAL- NAME / DATE:

REVISIONS: (Refer to dwg # revision sheet)

OUTLINE DRAWING

STANDARD NOTES: (Unless Otherwise Specified)

ALL DIMENSIONS ARE IN INCHES
DRAWING INTERPRETATION DIMS. PER ASME-Y14.5M
REMOVE BURRS AND BREAK SHARP EDGES .005 - .015
THREADS PER HANDBOOK H-28
DIMENSIONS ARE SHOWN AFTER PLATING

ANGLE:
± 1/2°

CHAMFER:
± 5°

TOLERANCE:
.X ± 0.1"
.XX ± 0.01"
.XXX ± 0.005"

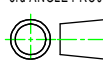

This drawing is submitted solely for the information and exclusive use of the original addressee. It is not to be divulged in whole or in part, by any firm or individual without written permission from:

FUTEK
ADVANCED SENSOR TECHNOLOGY, INC.

MODEL: QLA285	DWG No.: FO1476
DRAWN BY: S. MICHEL	CREATED DATE: 8/24/2018
APPROVED BY: R. WALKER	APPROVED DATE: 9/13/2018
CHECKED BY:	CAGE: 1X8M6 SHEET: 1 OF 1