

# FUTEK MODEL QLA387

## CUSTOM SUBMINIATURE LOAD BUTTON LOAD CELL

ITEM NUMBER: QSH02344



INCH [mm]		R.O.= Rated Output	
WIRING CODE			
+ Excitation	- Excitation	+ Signal	- Signal
RED	BLACK	GREEN	WHITE
Shield			
TO SENSOR			
BODY			

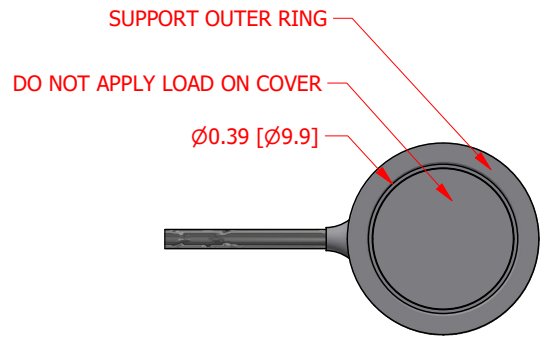
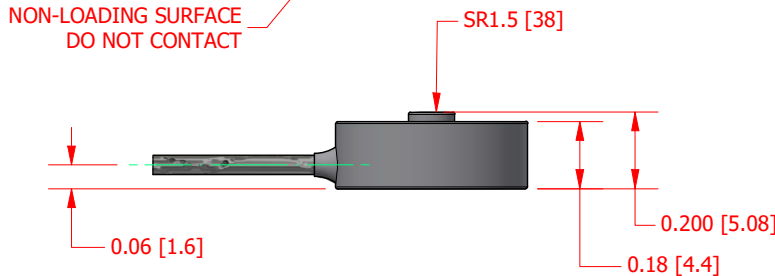
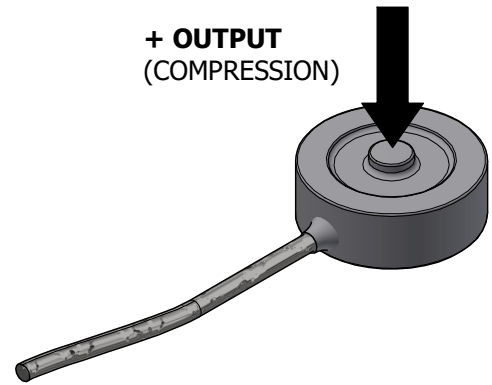
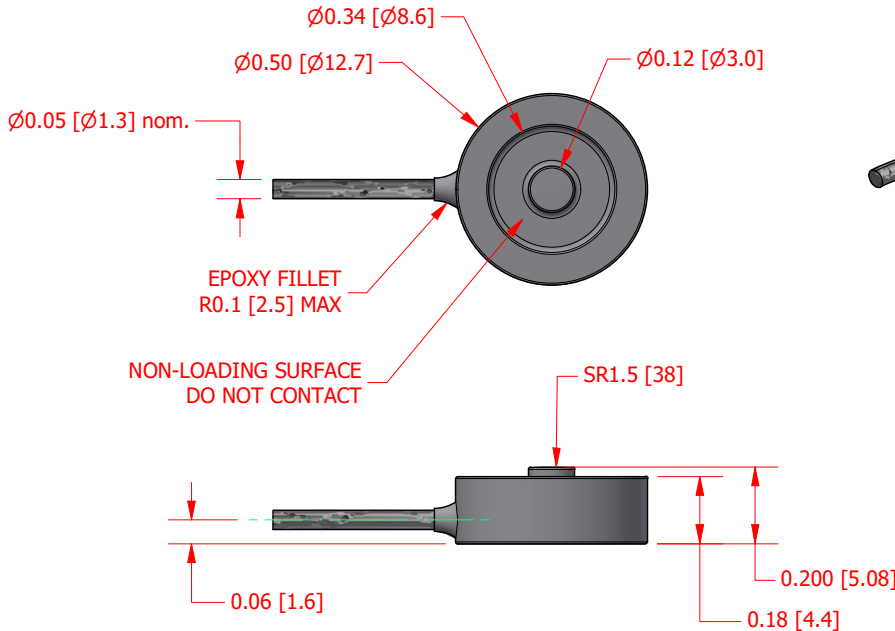

### SPECIFICATIONS:

RATED OUTPUT	1.5 mV/V nom.
CAPACITY	500 lb. [2220N]
MAX OVERLOAD	500 lb [2224 N]
ULTIMATE/STRUCTURE OVERLOAD	750 lb [3336 N]
ZERO BALANCE	±5% of R.O.
EXCITATION (VDC OR VAC)	7 MAX
BRIDGE RESISTANCE	1000 Ω nom.
NONLINEARITY	±0.5% of R.O.
HYSTERESIS	±0.5% of R.O.
NONREPEATABILITY	±0.5% of R.O.
TEMP. SHIFT ZERO	±0.01% of R.O./°F (±0.018 of R.O./°C)
TEMP. SHIFT SPAN	±0.02% of LOAD/°F (±0.036 of LOAD/°C)
COMPENSATED TEMP.	60 to 160 °F (16 to 71 °C)
OPERATING TEMP	-60 to 200 °F (-51 to 93 °C)
WEIGHT (approx)	0.01 lb [3.2 g]
MATERIAL	17-4 PH S.S.
DEFLECTION	0.0005 [0.013] nom.
IP RATING	IP64
FATIGUE LIFE	100,000 CYCLES @500lb

CABLE: #34 Awg 4 Conductor Braided Shielded Cable, Teflon Conductors 10 ft [3.05 m] Long

**DSPM Industria**  
sensori & trasduttori

Via Paolo Uccello 4 - 20148 Milano  
Tel +39 02 48 009 757 Fax +39 02 48 002 070  
info@dspmindustria.it www.dspmindustria.it

CUSTOMER APPROVAL- COMPANY:

CUSTOMER APPROVAL- NAME / DATE:

REVISIONS: (Refer to dwg # revision sheet)

## OUTLINE DRAWING

STANDARD NOTES: (Unless Otherwise Specified)

ALL DIMENSIONS ARE IN INCHES  
DRAWING INTERPRETATION DIMS. PER ASME-Y14.5  
REMOVE BURRS AND BREAK SHARP EDGES .005 - .015  
THREADS PER HANDBOOK H-28  
DIMENSIONS ARE SHOWN AFTER PLATING

ANGLE:  
± 1/2°

CHAMFER:  
± 5°

TOLERANCE:  
.X ± 0.1"  
.XX ± 0.01"  
.XXX ± 0.005"

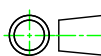

# FUTEK

This drawing, including all information depicted herein (collectively, "Drawing"), is FUTEK's property and protected under applicable law, including copyright. FUTEK reserves all rights. The Drawing is provided solely for your information and exclusive use. Except as expressly approved by FUTEK in writing, you may not reproduce or share this Drawing, in whole or part, with any other firm or individual, or attempt to reverse engineer the Drawing or data contained therein. Any reproduction of this Drawing in whole or part must include this legend.

MODEL: <b>QLA387</b>	DWG No.: <b>F01634-0</b>
DRAWN BY: <i>S. VOSOUGH</i>	CREATED DATE: <i>8/10/2023</i>
APPROVED BY: <i>M. ILLES</i>	APPROVED DATE: <i>8/10/2023</i>
CHECKED BY:	CAGE: 1X8M6 SHEET: 1 OF 1