

NOTE:- READ INSTALLATION SHEET X103-19 FOR FULL INSTRUCTIONS FOR USE.

ATEX / IECEx APPROVED TO
 II 1G
 Ex ia IIC T4 Ga (Ta= -40° to +80°C)
 Ui 11.4V, li 0.2A, Pi 0.51W

APPROVED FOR USE IN CONJUNCTION WITH A GALVANICALLY ISOLATED BARRIER.

NOTE: APPROVAL ONLY APPLIES AT NORMAL ATMOSPHERIC PRESSURE!

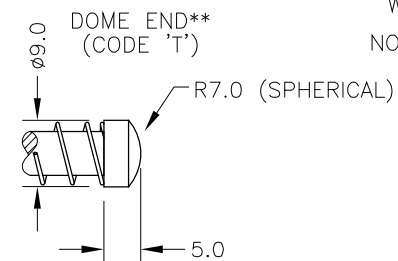

IP67 SHORT CABLE GLAND (CODE 'Mxx'/'MQxx')

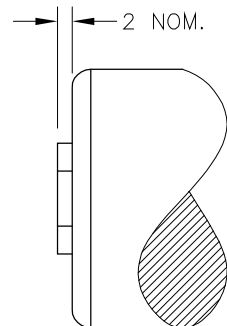

NOTE: SENSORS WITH TRAVEL UP TO 50mm ARE MADE IN STANDARD LENGTHS.

TRAVEL: (mm)	BODY LENGTH: (mm)
CALIBRATED	MECHANICAL 'X' STANDARD 'Y' FLANGE
0-2 TO 0-10	10 65.0 81.3
0-11 TO 0-20	20 75.0 91.3
0-21 TO 0-30	30 85.0 101.3
0-31 TO 0-50	50 105.0 121.3

GAIN AND OFFSET ADJUSTMENTS SEALED (CODE 'Y')

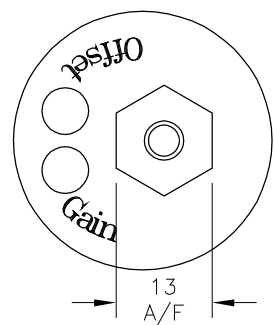

THE PLUNGER RETRACTS 5mm FROM START OF CALIBRATED TRAVEL (2mm FOR SPRUNG VERSIONS) AND EXTENDS 9.5mm* BEYOND END OF MECHANICAL TRAVEL. *DOES NOT INCLUDE DIFFERENCE BETWEEN CALIBRATED AND MECHANICAL TRAVEL, DIMENSIONS ARE NOMINAL. 'V' CODED PLUNGER WILL DEPART SENSOR BODY.

DRAWINGS NOT TO BE CHANGED WITHOUT REFERENCE TO THE CHANGE PROCEDURE. CHANGES TO PARTS USED IN INTRINSICALLY SAFE PRODUCT MUST BE APPROVED BY THE AUTHORISED PERSON. THIS IS AN UNCONTROLLED PRINT AND WILL NOT BE UPDATED.

L	STROKE NOTES AMENDED.	PDM
M	STANDARD VERSION AMENDED - RAN467.	PDM
N	APPROVAL STANDARDS UPDATED - RAN465.	PDM
O	STROKE 2-10 WAS 10 - RAN1063	PDM
P	5-CORE OPTION ADDED ~ RAN1102	PDM
Q	RANGE NOTE AMENDED ~ RAN1200	PDM

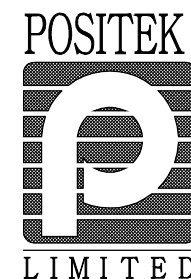

L	21/11/13		CHECKED BY	X ±0.4
M	10/12/13		RDS	X.X ±0.2
N	10/03/14			X.XX ±0.1
DESCRIPTION				
O	10/11/15	X103 INTRINSICALLY SAFE		
P	10/04/17	SHORT STROKE LINEAR		
Q	29/08/17	POSITION SENSOR		
SCALE 10mm		DRAWING NUMBER		X103-11
		REV		Q
				SHEET 1 OF 1