

ZX-PA Series – Installation Guide

Specifications

Potentiometer Value..... 5000 Ω \pm 10%
 Excitation Voltage (+Ve) 30 VDC Max.
 Linearity..... \pm 1.0% Full Scale
 Operating Temperature..... -55°C to 100°C

Electrical Cable Wiring

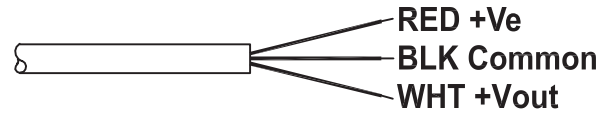

Dimensional Information

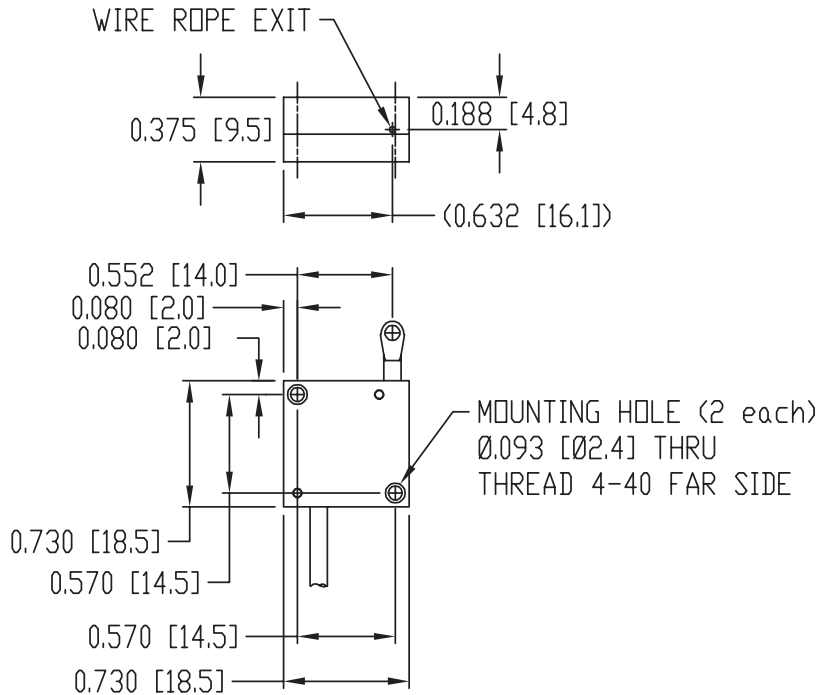

OPTION A – Eye Fitting

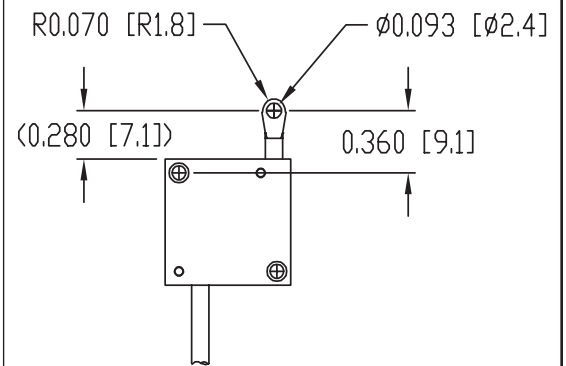

OPTION B – Leader Wire Rope with Clip

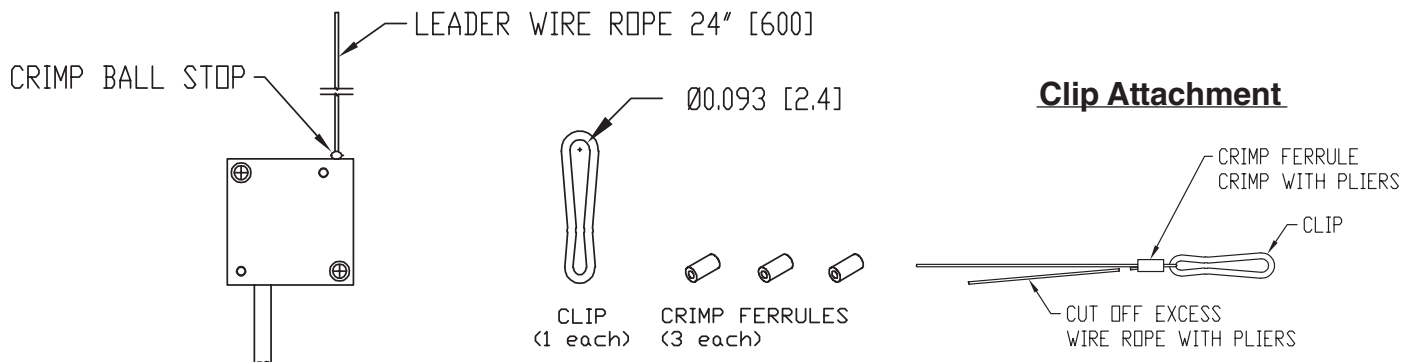

Dimensions in brackets are in millimeters

400261a.indd, 400261a.pdf