

# FUTEK MODEL LBB300 (L1510)

# ROUND SHAFT BEAM LOAD CELL

**Drawing Number: FI1050**

**INCH [mm] | R.O.= Rated Output**

**WIRING CODE (WC1)**

+Excitation	-Excitation	+Signal	-Signal
RED	BLACK	GREEN	WHITE

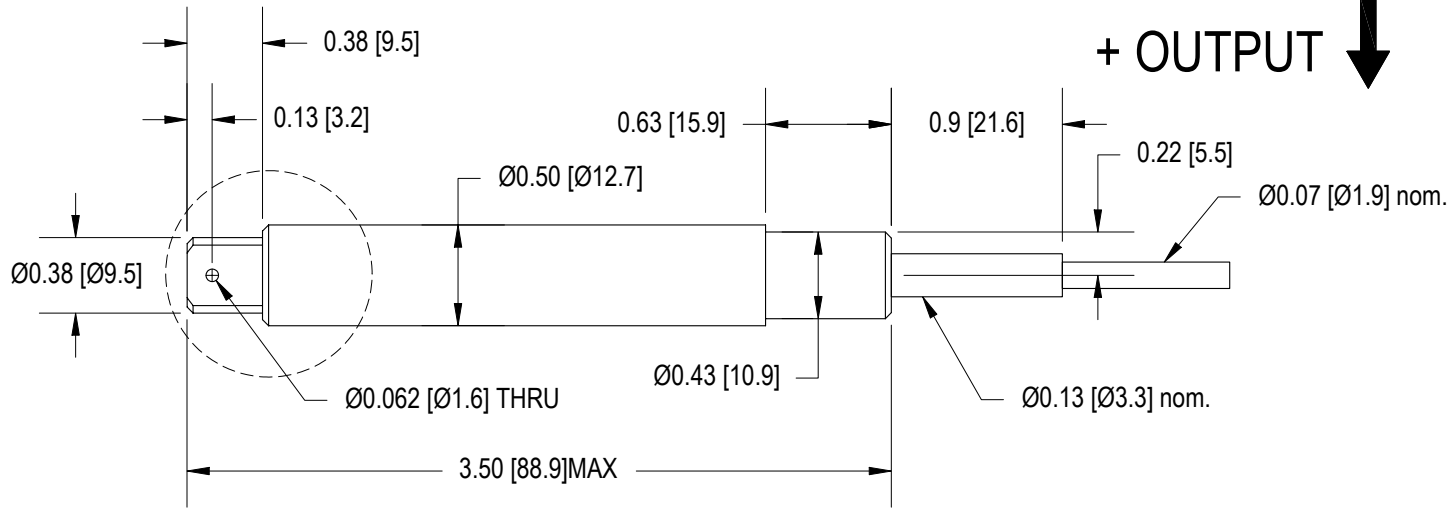
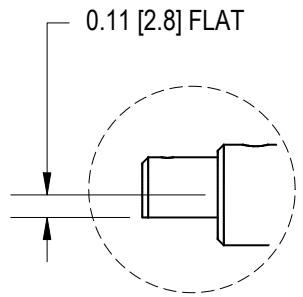
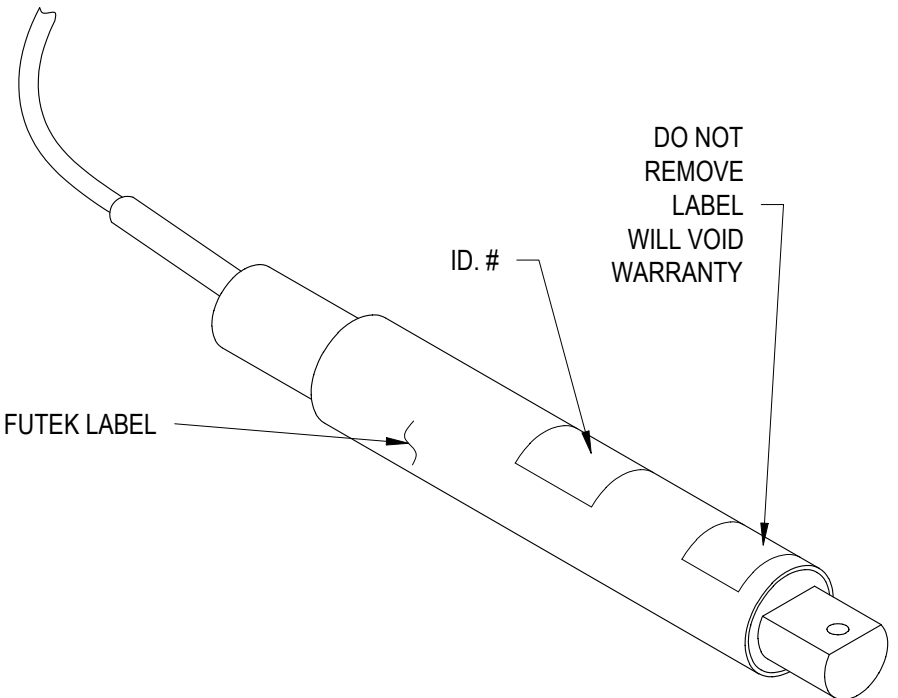

**SPECIFICATIONS:**

**RATED OUTPUT** 2 mV/V nom.  
**SAFE OVERLOAD** 400% (0.25 to 5 lb)  
 200% (10 lb)  
**ZERO BALANCE** ±3% of R.O.  
**EXCITATION (VDC OR VAC)** 7 MAX (0.25 to 5 lb) 18 MAX (10 lb)  
**BRIDGE RESISTANCE** 350 Ω nom.  
**NONLINEARITY** ±0.05% of R.O.  
**HYSTERESIS** ±0.05% of R.O.  
**NONREPEATABILITY** ±0.03% of R.O.  
**TEMP. SHIFT ZERO** ±0.005% of R.O./°F [0.01% of R.O./°C]  
**TEMP. SHIFT SPAN** ±0.005% of LOAD/°F [0.01% of LOAD/°C]  
**COMPENSATED TEMP.** 60 to 160°F [15 to 72°C]  
**OPERATING TEMP.** -60 to 200°F [-50 to 93°C]  
**WEIGHT** 1 oz [28 g]  
**MATERIAL** ALUMINUM  
**DEFLECTION** 0.007 to 0.018 [0.18 to 0.46] nom.  
**CABLE:** #29 AWG, 4 Conductor, Spiral Shielded Teflon Cable 10 ft [3 m] Long  
**ACCESORIES AND RELATED INSTRUMENTS AVAILABLE**  
**CALIBRATION (STD)** 5 pt. COMPRESSION; 60K Ω SHUNT CAL. VALUE  
**CALIBRATION TEST EXCITATION** 5 VDC (0.25 to 5 lb) 10 VDC (10 lb)

CAPACITIES		
STK #	lb	N
FSH00934	0.25	1.1
FSH00935	0.5	2.2
FSH00936	1	4.5
FSH00937	1.5	6.7
FSH00938	2	8.9
FSH00939	5	22.2
FSH00940	10	44.5